

Need 3 per set. Attaches to top of claw base.

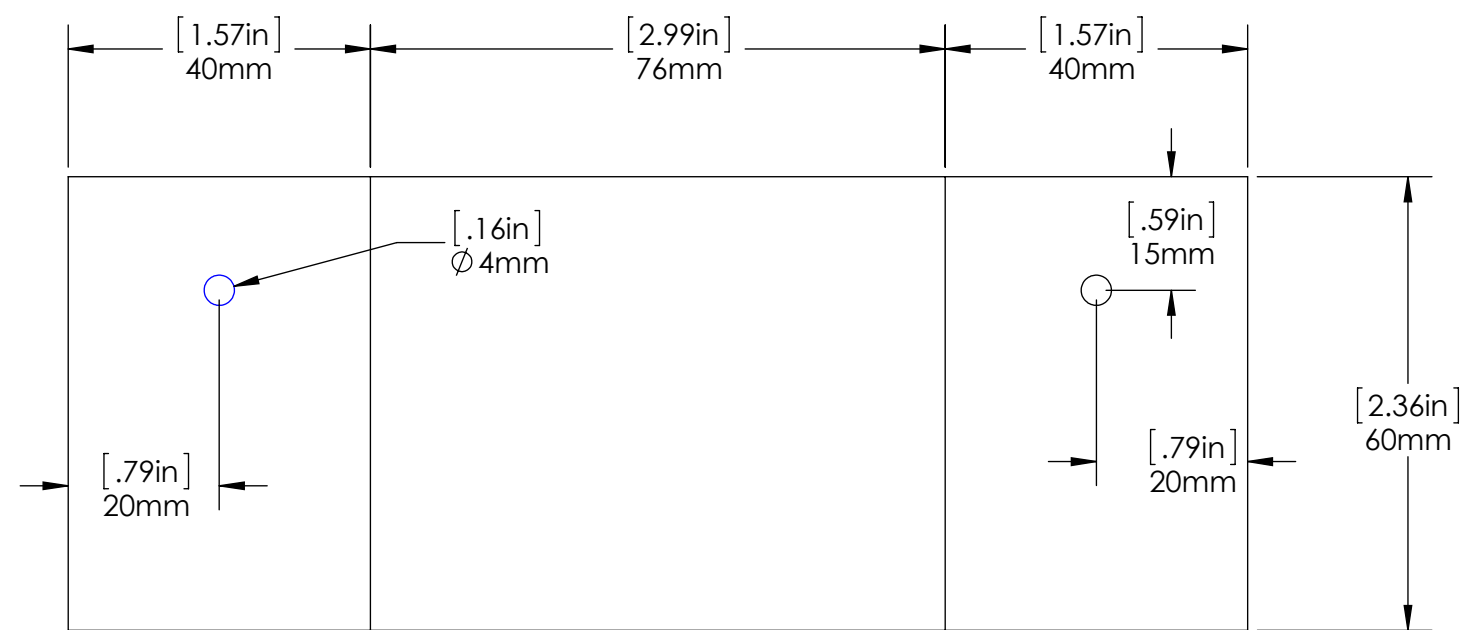

Base of the claw

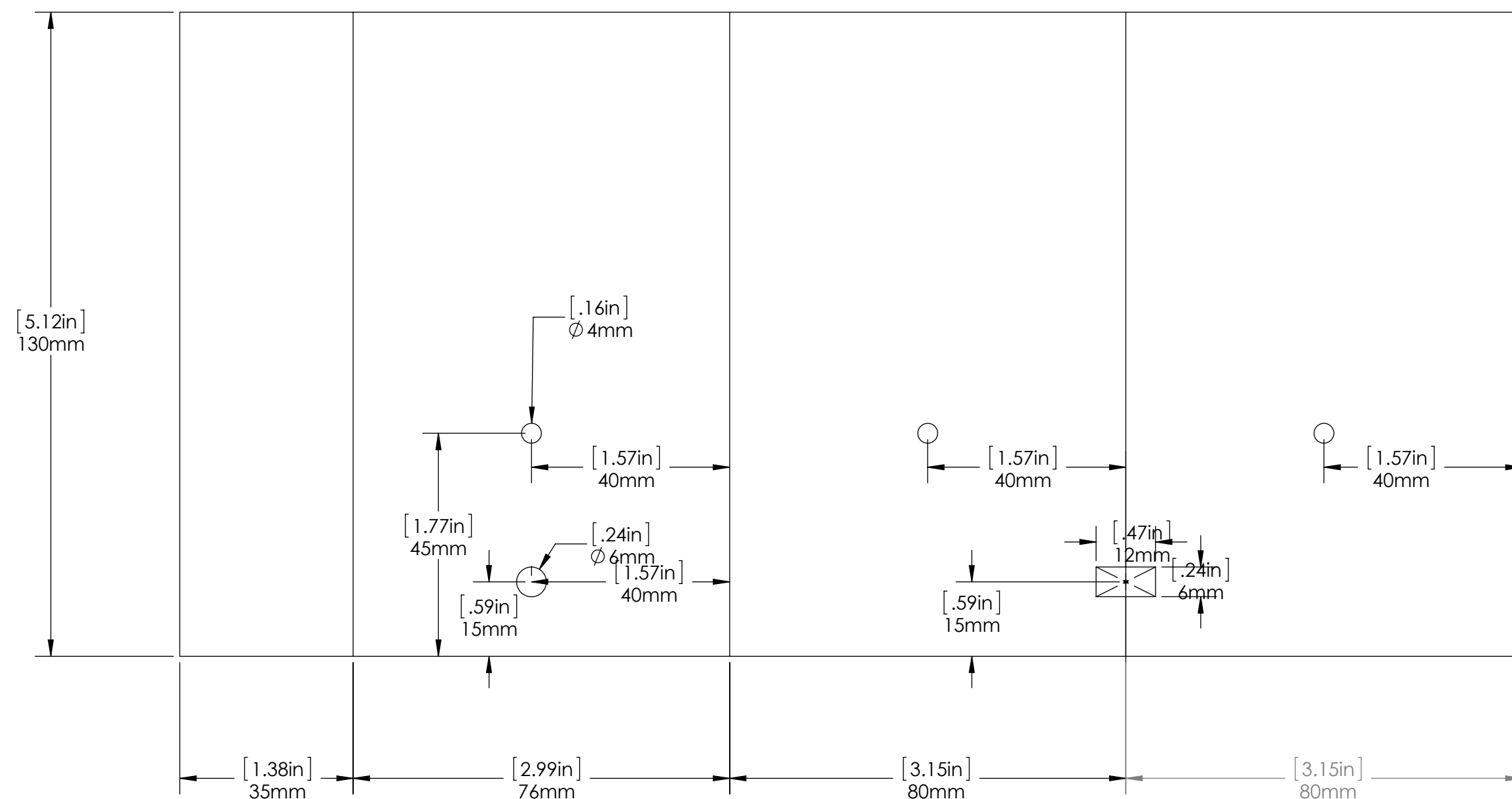

Attaches to base.
Small stepper motor mounted inside

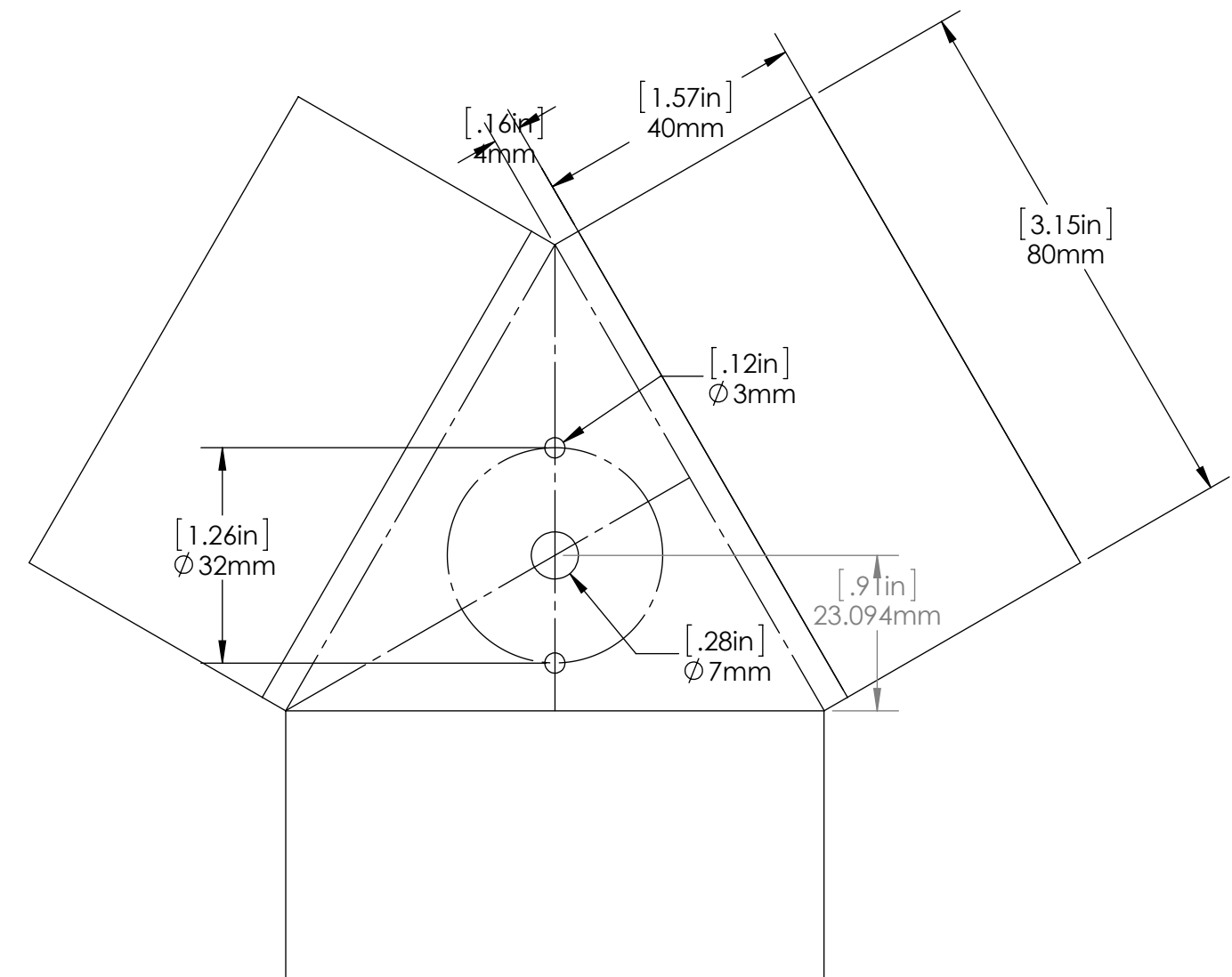

UNLESS OTHERWISE SPECIFIED: DIMENSIONS ARE IN MILLIMETERS				FINISH:		DEBUR AND BREAK SHARP EDGES		DO NOT SCALE DRAWING		REVISION	
SURFACE FINISH:				TOLERANCES:		LINEAR:		ANGULAR:		TITLE:	
DRAWN:	NAME	SIGNATURE	DATE								
CHKD:											
APP'VD:											
MFG:											
Q.A:						MATERIAL:					
						WEIGHT:		SCALE:1:1		SHEET 1 OF 4	

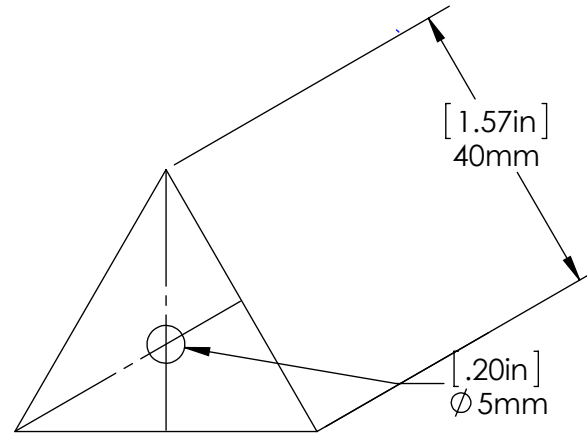

This equilateral triangle is cut from a piece of 1x2 wood. The 40mm dimension can be changed to suit materials at hand.

This triangular piece attaches to the threaded nut that moves linearly in or out, which in turn opens and closes the claw.

Glued to this piece are 6 pieces of 20mm wood cut from 3/8" square trim (not shown)

Need 6 per set. Fingers of the claw.

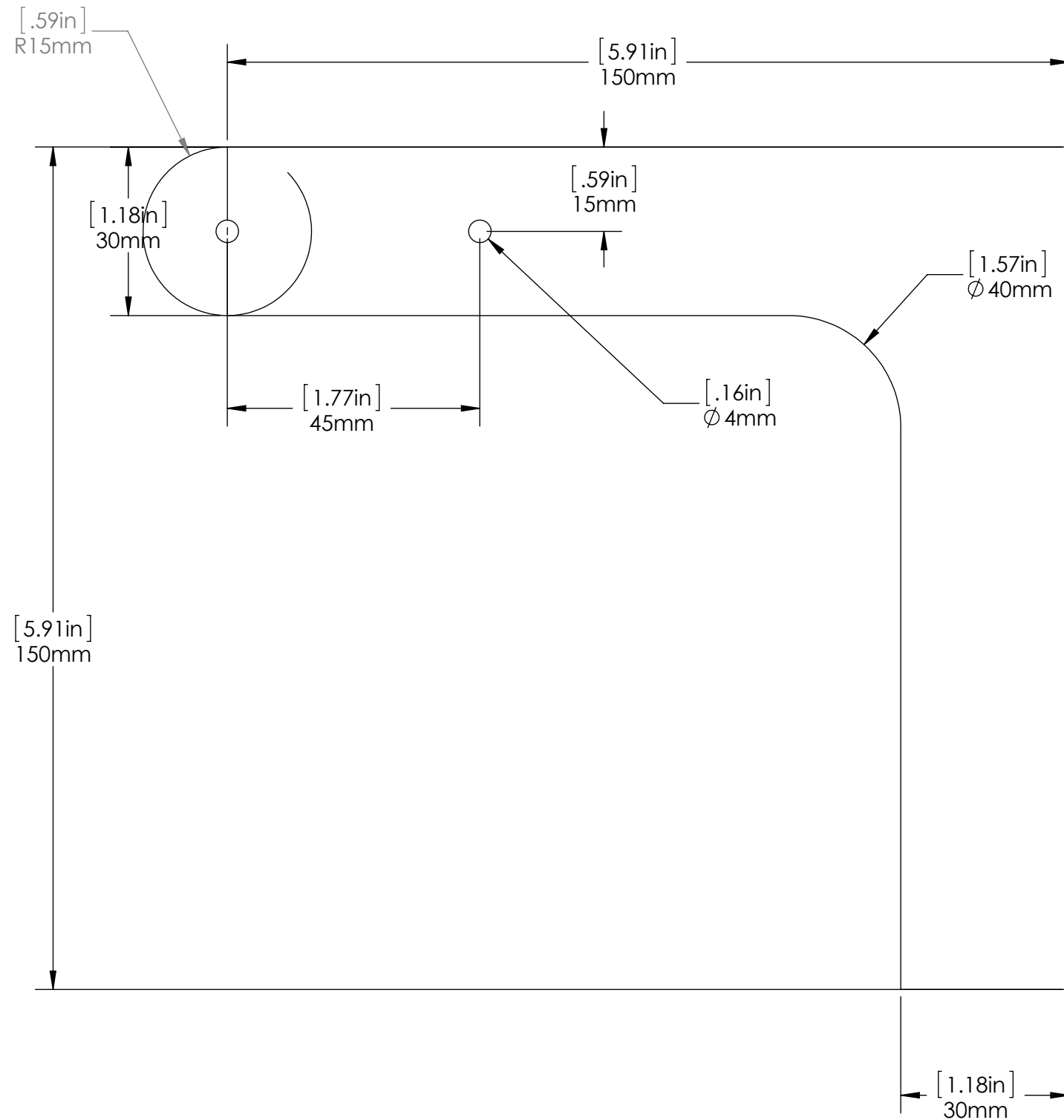

Need 3 per set. Fingers pivot on these pieces.

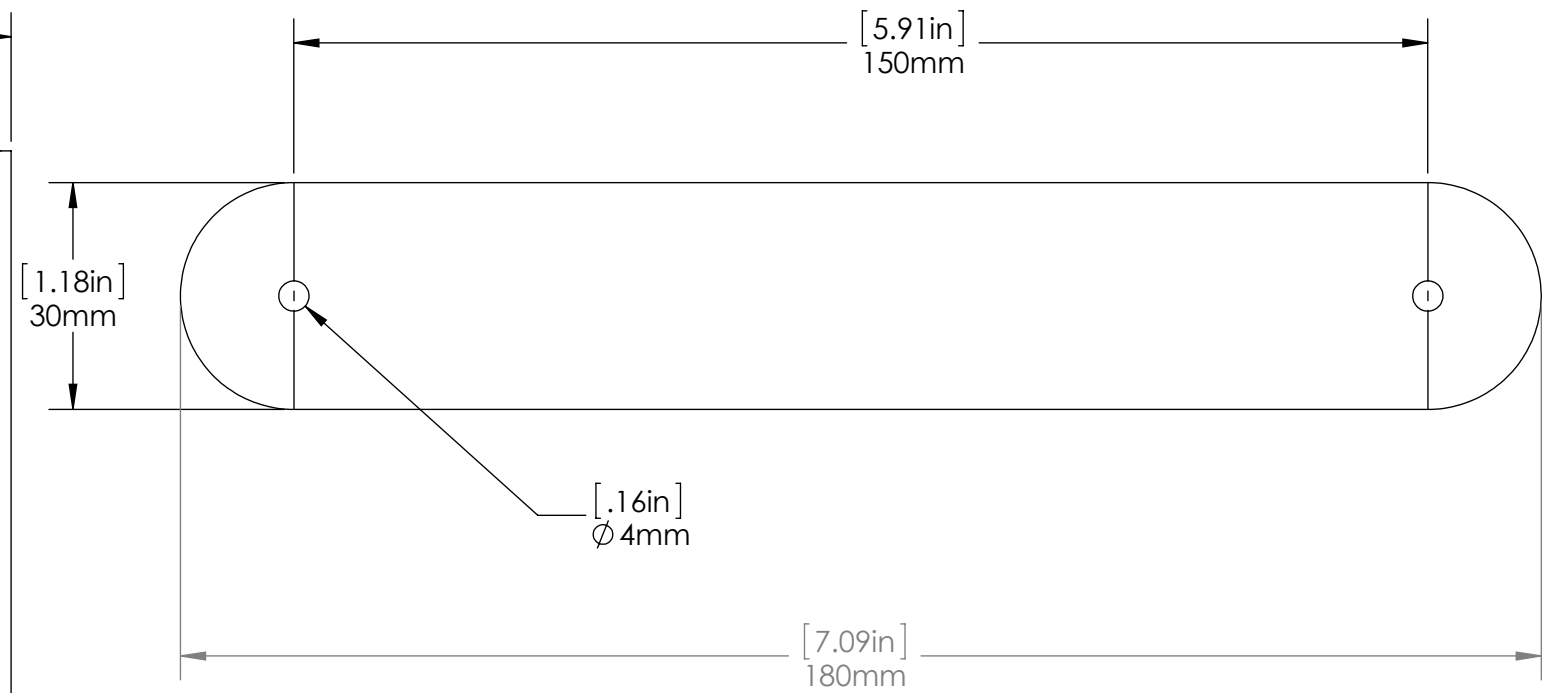

Need 3 per set. Glued to triangular wooden piece

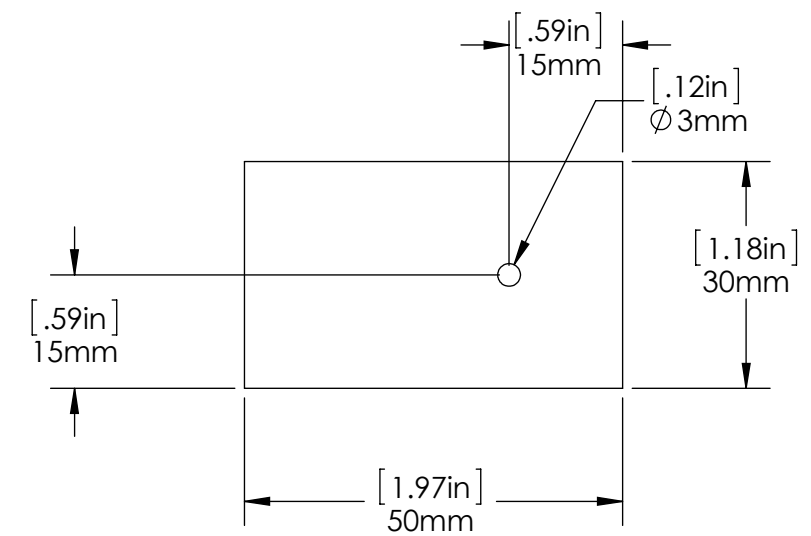

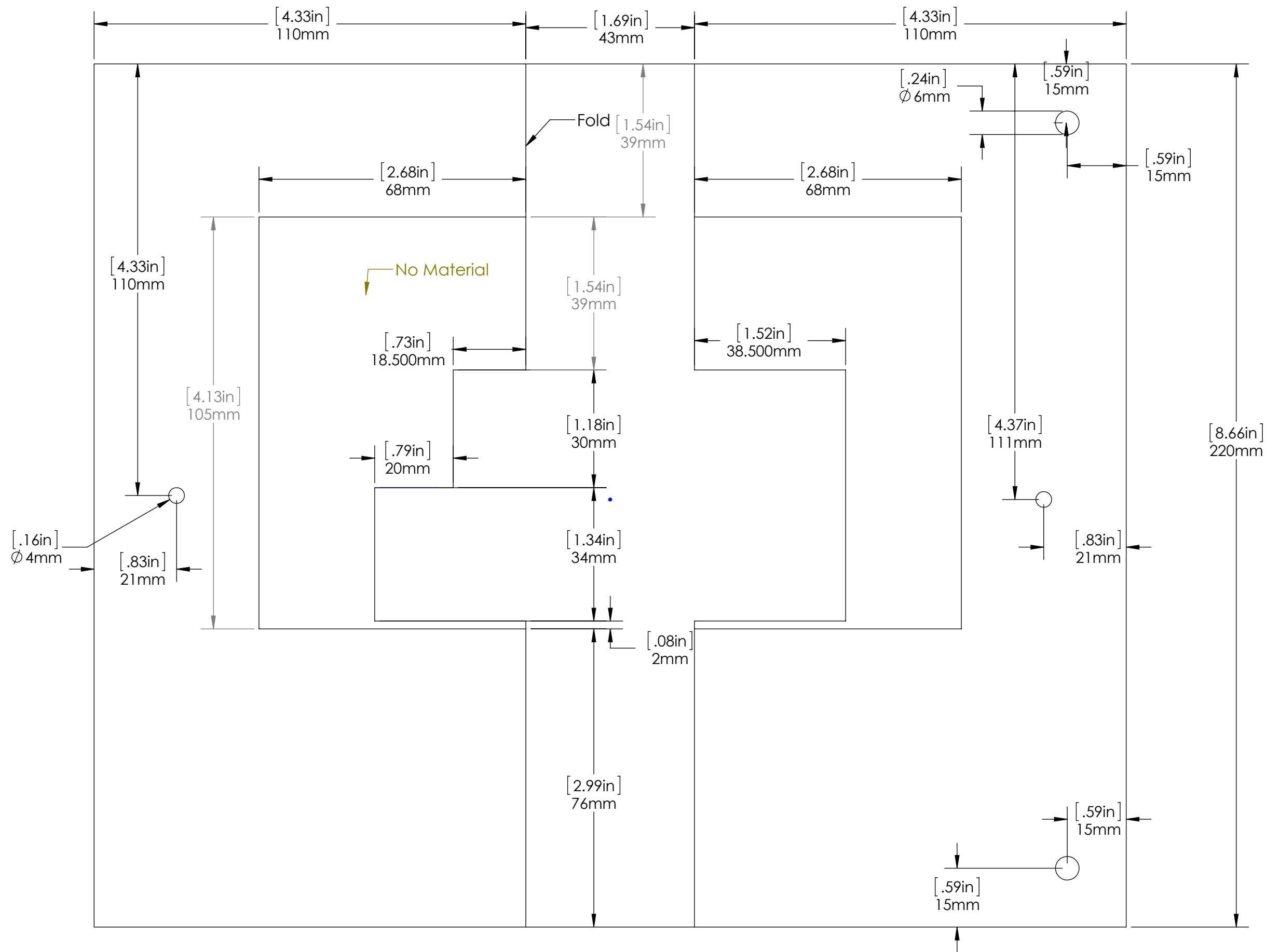

Camera attachment for iPhone. Modify for other cameras