

Find IP and MAC Addresses

Windows Key + R

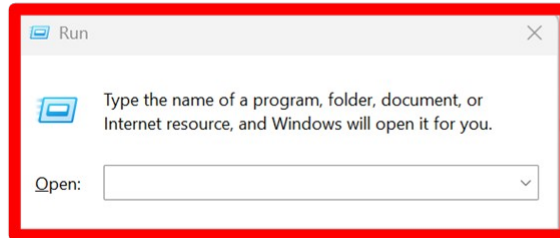

Open "Run" box



cmd [space] /k [space] ipconfig [space] /all

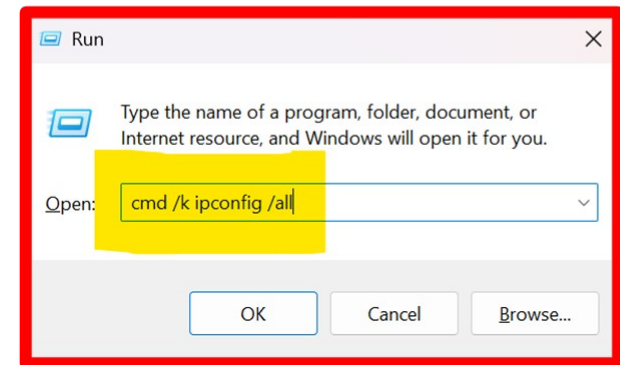

Physical address is MAC address

IPv4 is IP address

```
Wireless LAN adapter Wi-Fi:
Connection-specific DNS Suffix . : Nagarro.local
Description . . . . . : Intel(R) Dual Band
Physical Address. . . . . : 84-FD-D1-11-DB-0E
DHCP Enabled. . . . . : Yes
Autoconfiguration Enabled . . . . : Yes
Link-local IPv6 Address . . . . . : fe80::f25f:d386:b4f
IPv4 Address. . . . . : 10.177.104.59(Prefe
Subnet Mask . . . . . : 255.255.255.0
Lease Obtained. . . . . : Tuesday, July 29, 2
Lease Expires . . . . . : Wednesday, July 30,
Default Gateway . . . . . : 10.177.104.1
DHCP Server . . . . . : 10.6.50.50
DHCPv6 IAID . . . . . : 109379025
DHCPv6 Client DUID. . . . . : 00-01-00-01-24-8F-0
DNS Servers . . . . . : 10.6.50.10
                        10.127.129.10
                        8.8.8.8
                        10.127.127.9
NetBIOS over Tcpi. . . . . : Enabled
```

Click "Ok"

Single Command to Find IP Address



This takes the output of the "ipconfig /all" command and sends it [using a "pipe"] into the "findstr" command which searches the output for "IPv4"

Once "findstr" catches the string, it sends the whole line to the screen

Release and Renew IP Addresses

